



## TFM Treamo Finance Monitor

Overview / Setup Scenarios / Tools



Cash flow forecasting

Management of cash pools

Liquidity management

Cash reporting



Identification of FX exposures

Reporting of net FX exposures

Management of counterparty risks

## Integration with bank platforms

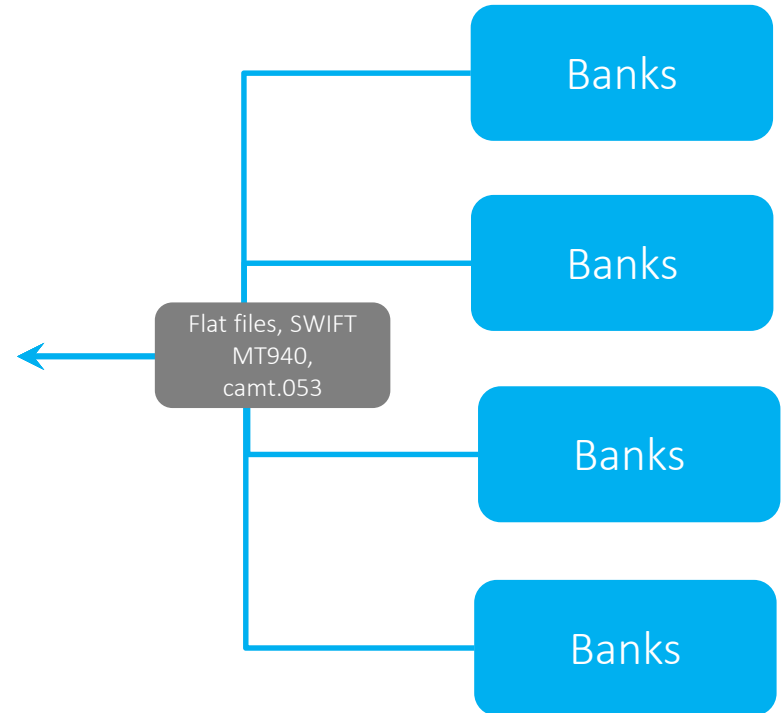

Integration with bank platforms and ERP systems

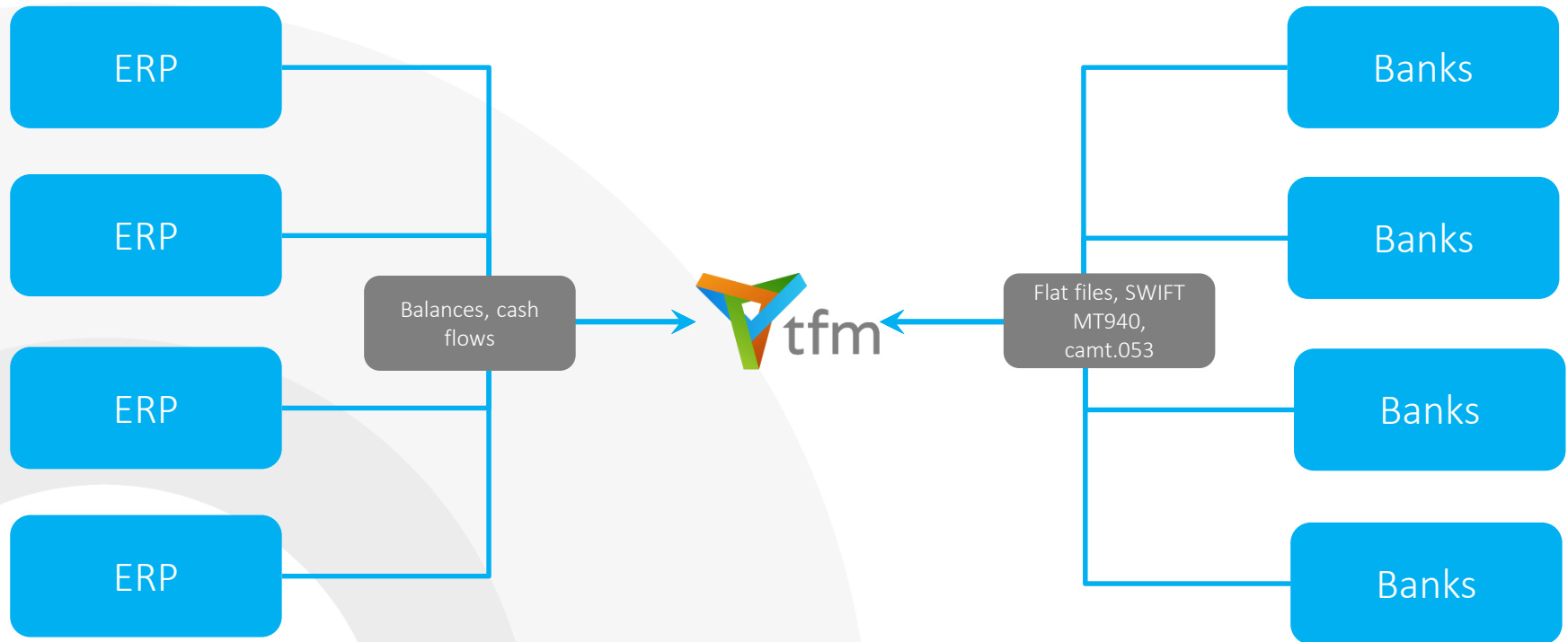

Integration with bank platforms, ERP systems, TMS

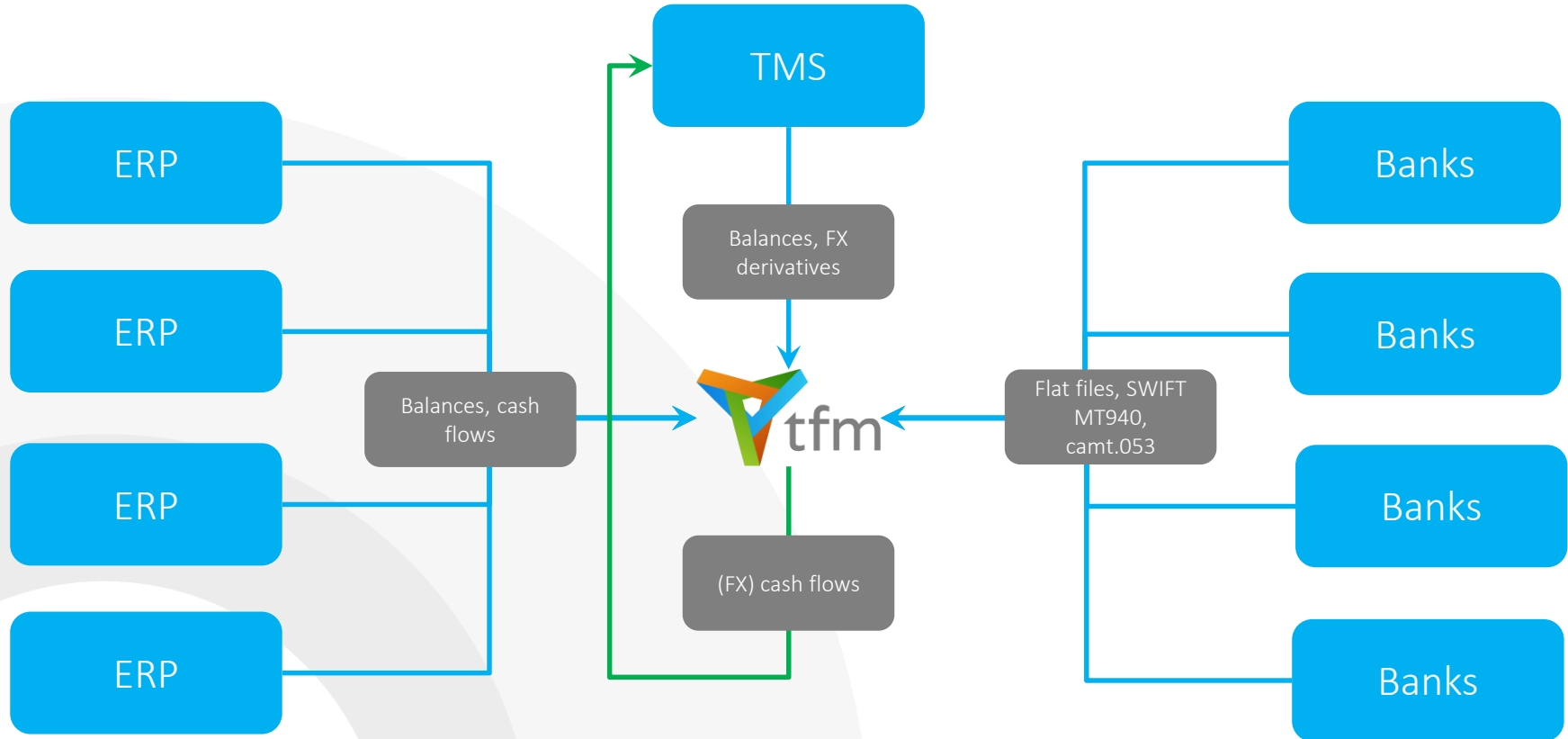

Integration with bank platforms, ERP systems, TMS, trading platform

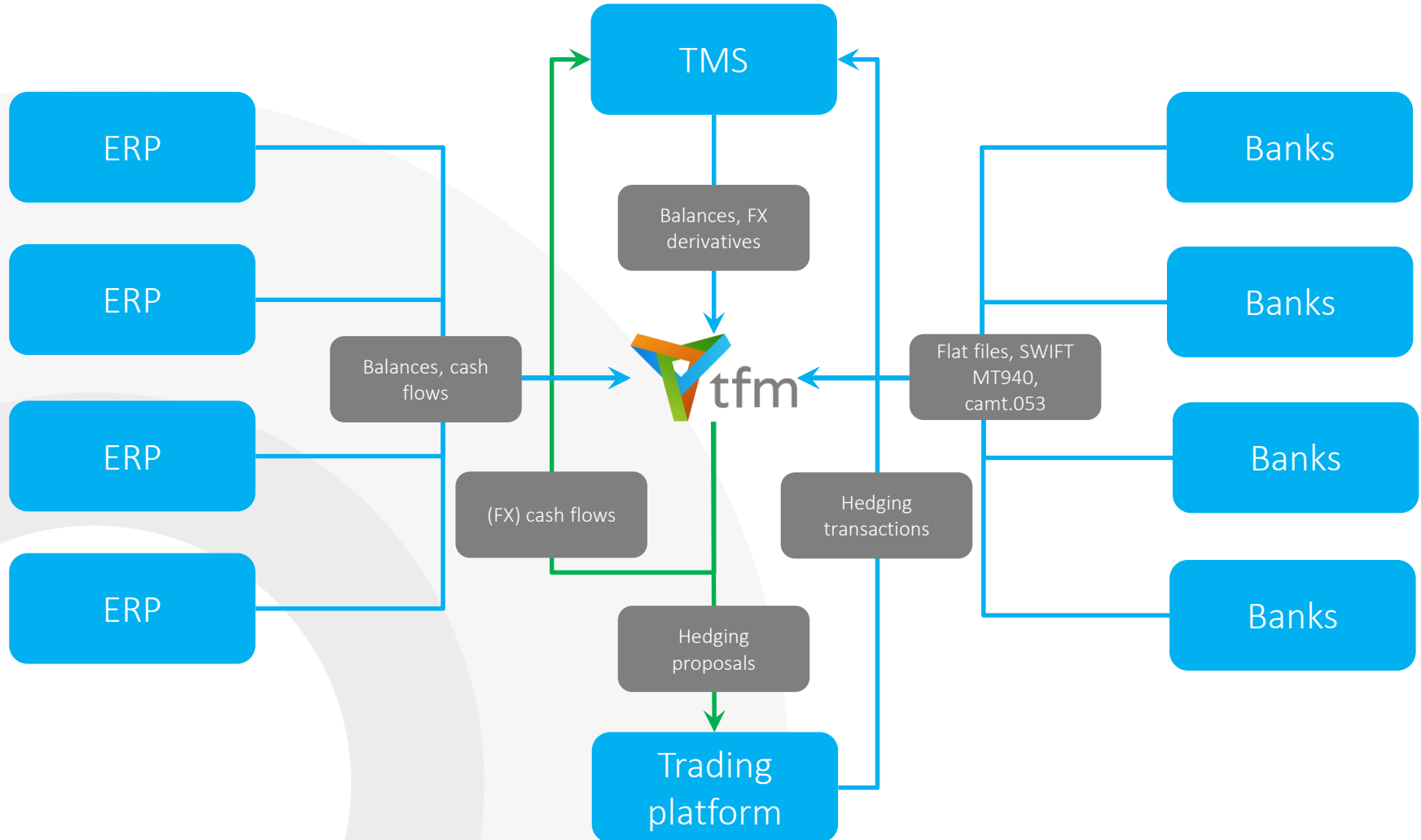

Budget to Cash flow – convert your budget into cash flows

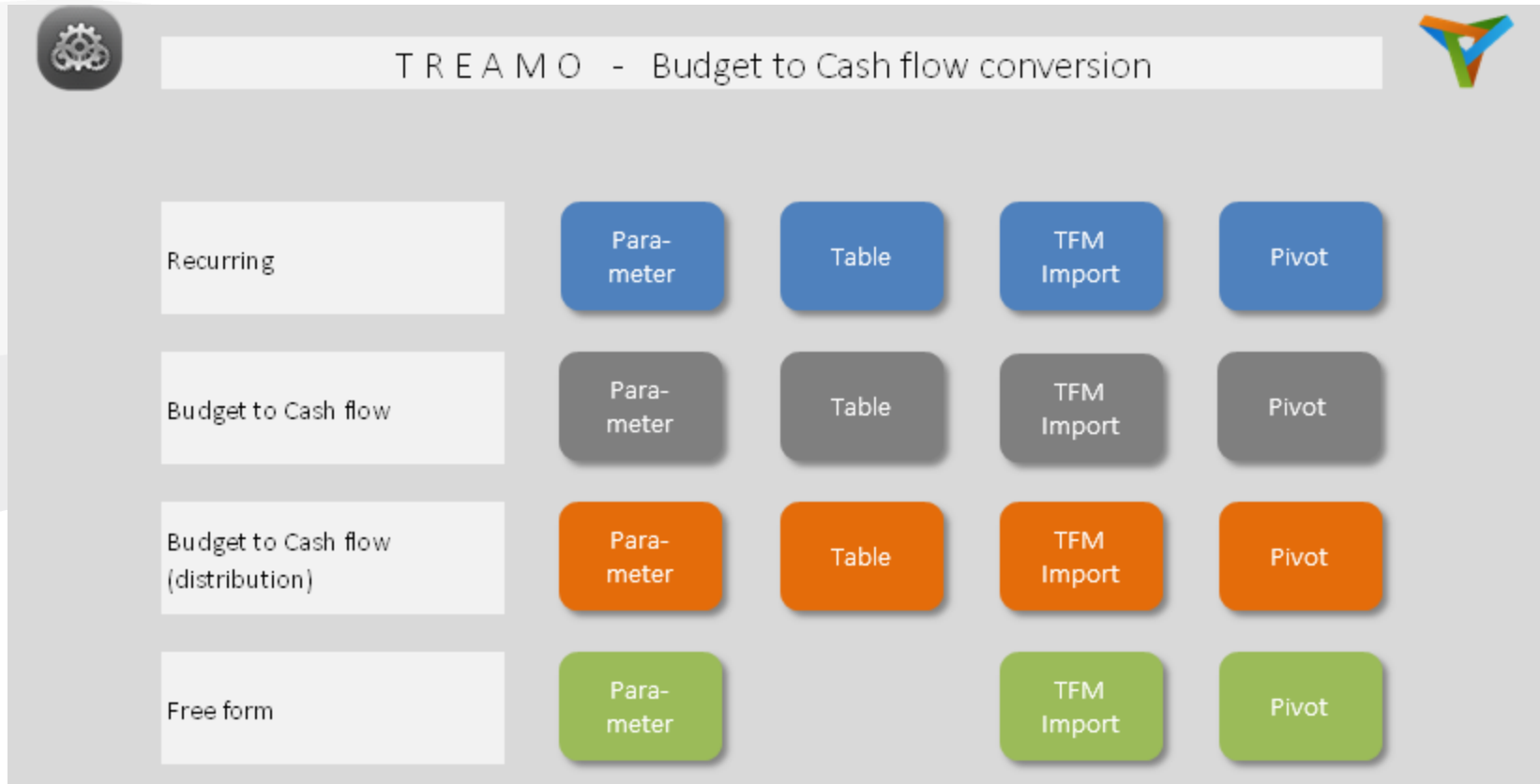

The screenshot shows a software interface titled "TREAMO - Budget to Cash flow conversion". On the left, there is a vertical list of four categories: "Recurring", "Budget to Cash flow", "Budget to Cash flow (distribution)", and "Free form". To the right of each category is a grid of four buttons: "Parameter", "Table", "TFM Import", and "Pivot". The buttons are color-coded: blue for "Recurring", grey for "Budget to Cash flow", orange for "Budget to Cash flow (distribution)", and green for "Free form". A gear icon is in the top left corner, and a colorful logo is in the top right corner.

Category	Parameter	Table	TFM Import	Pivot
Recurring	Parameter	Table	TFM Import	Pivot
Budget to Cash flow	Parameter	Table	TFM Import	Pivot
Budget to Cash flow (distribution)	Parameter	Table	TFM Import	Pivot
Free form	Parameter		TFM Import	Pivot

Budget to Cash flow – convert your budget into cash flows

Based on individually definable parameters (e.g. distribution of inflows resulting from sales over the following months, currencies, etc.), the budgeted values can be converted into cash flows and imported in TFM.

The Excel-based tool can be configured to interact with any ERP system that can provide data exports in csv or Excel format

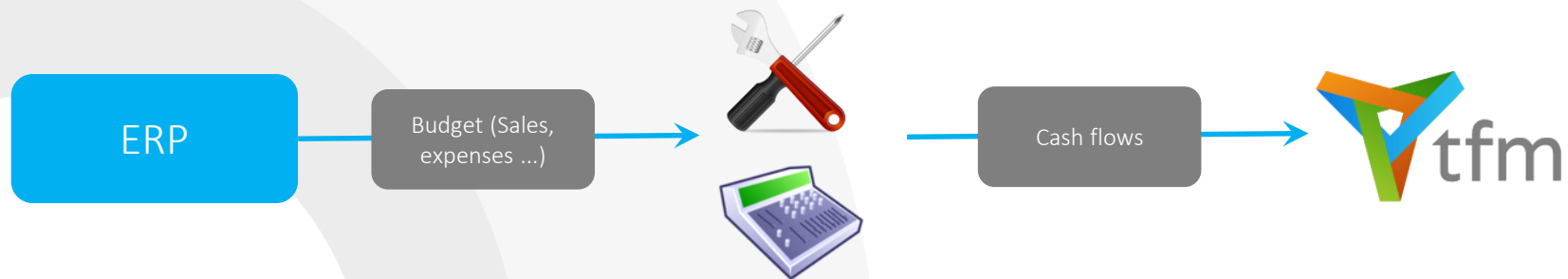



## Cash flow forecast – Scenario calculations



### T R E A M O - Forecast Scenario Calculator (Treamo Demo Environment)



Scenario 1 - General %-factors or amounts / forecast line, dependencies



Scenario 2 - Individual %-factors / month



Original data



Drive	D:\
Directory	D:\Arbeitsordner\Business\Treamo\TFM Treamo Finance Monitor\Cash Flow Scenario\Import Files
File Name Import 1 Full	TFM-CF-Treamo-Demo-Import-Scenario-V1-Full-2018-06-07-15-53-40.xlsx
File Name Import 1 Delta	TFM-CF-Treamo-Demo-Import-Scenario-V1-Delta-2018-06-07-15-53-40.xlsx
File Name Import 2 Full	TFM-CF-Treamo-Demo-Import-Scenario-V2-Full-2018-06-07-15-53-40.xlsx
File Name Import 2 Delta	TFM-CF-Treamo-Demo-Import-Scenario-V2-Delta-2018-06-07-15-53-40.xlsx
Tool	CF-Scenario-Analysis-Demo.xlsm

## Cash flow forecast – Scenario calculations

Based on individually definable parameters (e.g. change by +/- x% or change by absolute amounts) actual cash flows can be amended and either imported in a new forecast version or e.g. only delta values can be imported in the original forecast version.

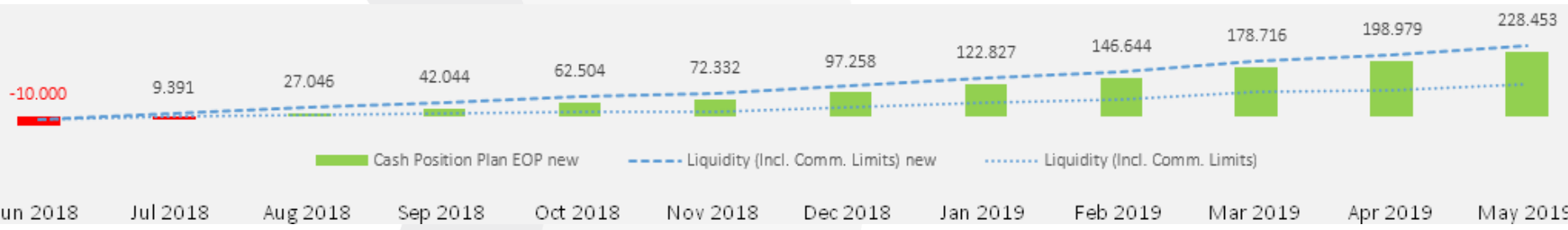

Identify FX cash flows, check against limits, prepare hedging transactions



## TREAMO - FX Analysis / Group-internal hedging



**Hedging Entity**

**Value Date**

**Day / Month for Hedging**

Saturday / Sunday Rule

**Hedges on Saturdays**  days

**Hedges on Sundays**  days

**Base currency for FX rates**

Cash flows

Pivot Cash flows

Deal list

Pivot Entities

Hedge Flows HE

Hedge Flows LE

CCY Pairs	Hedge Ratio
EURAUD	80%
EURCAD	70%
EURGBP	60%
EURCHF	50%
EURUSD	60%
MXNUSD	50%
USDEUR	40%

Filter CCYs

db-markets

Identify FX cash flows, check against limits, prepare hedging transactions

Based on individually definable parameters (e.g. hedge ratios / hedge requirements), the identified FX exposures can be hedged by means of intra-group hedging transactions.

FX exposures will be identified automatically. The tool will then prepare suggestions which exposures should be hedged considering currency pairs and individual hedge ratios as well as of course amounts and maturities.

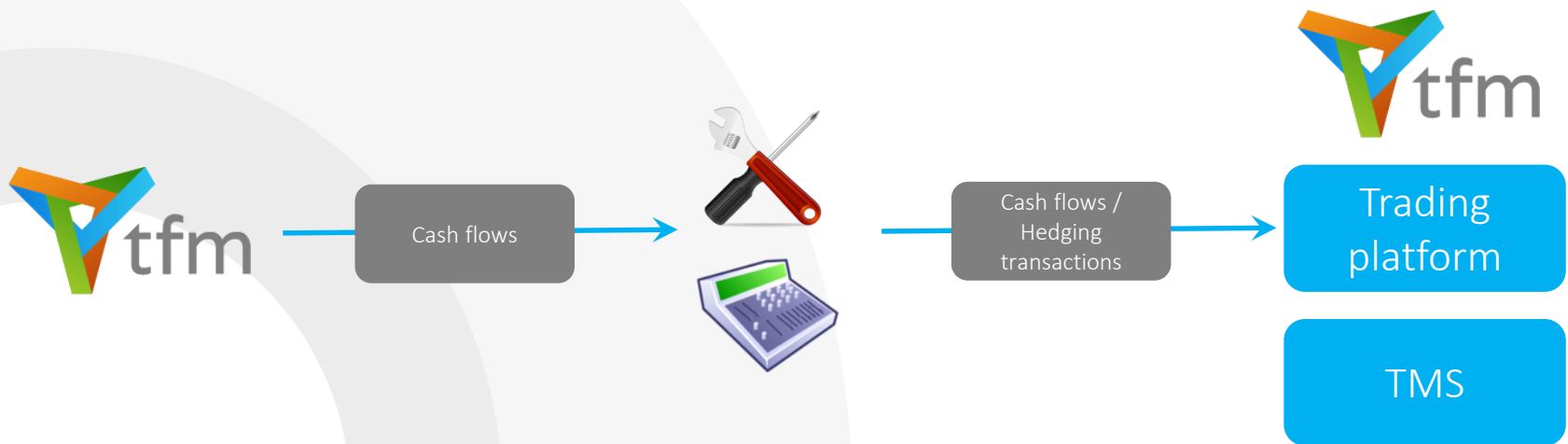

Treamo GmbH

Boesendorferstrasse 3  
1010 Vienna, Austria

+43/1/512 22 03  
[office@treamo.com](mailto:office@treamo.com)  
[www.treamo.com](http://www.treamo.com)

